

CUSTOM MADE LCD WITH COG (Chip-On-Glas) DRIVER

1. LCD Dimensions

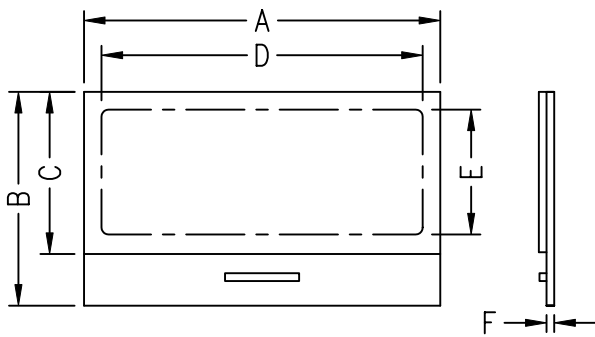

| | | | |
|------------------------|---------|--------|---------|
| A: Length | | | mm |
| B: Width | | | mm |
| C: Width | | | mm |
| D: Length viewing area | | | mm |
| E: Width viewing area | | | mm |
| F: Glass Thickness | 1,1 mm | 0,7 mm | 0,55 mm |
| Pin-Pitch: | 2,54 mm | 2,0 mm | 1,8 mm |
| Pin-Length: | 6,35 mm | | mm |
| FPC-Pitch : | 0,5 mm | | |
| FPC-Length: | | | mm |

2. LCD Configuration

Pin Connector

FPC

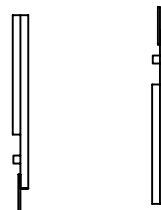
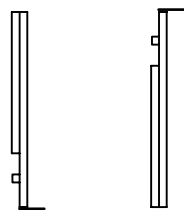

Viewing direction:

6 o'clock

12 o'clock

3. Electrical Characteristics

| | | | | | | |
|---------------------------|-----------------------|-----------------|-------|----------------|-----|-------|
| Type: | TN | STN | | | | |
| | | FSTN | | | | |
| Drive Method: | static | MUX: | | Voltage: | | V |
| Display Mode: | reflective | transflective | | transmissive | | |
| | positive | negative | | | | |
| Temperature Range: | Operating Temperature | 0°C bis +50°C | - | °C bis + | °C | |
| | Storage Temperature | -20°C bis +70°C | - | °C bis + | °C | |
| Backlight: | yes | no | | | | |
| Color: | white | blue | green | yellow-green | red | other |
| Backlight Mode: | | LED | | | | |
| Application: | indoor | outdoor | | UV-Protection | | |
| Soldering Methode (Pins): | | wave-soldering | | hand-soldering | | |

4. Contact

Quantity: pcs. / year Field of Application:

Name: Company:

Phone: e-mail: